

\$1,190,000 - 11 474012 Rge Road 242, Rural Wetaskiwin County

MLS® #E4451014

\$1,190,000

5 Bedroom, 3.50 Bathroom, 2,892 sqft

Rural on 8.01 Acres

Nordic Place, Rural Wetaskiwin County, AB

Commuterâ€™s Paradise! NORDIC PLACE-Approx 5 Mins East of Millet. This 8.01 Acre Property Has Been Landscaped by Nature With an Abundant Variety of Towering Trees & Offers Much Seclusion Without Isolation. Perched High Atop the Rolling Countryside with Peaceful Natural Views. This Architecturally Unique Tudor Style Home Appeals to Traditional Sensibilities, But Lovers of the Modern & Innovative Will Also Appreciate its Wonderful Blend of the Old & the New. FEATURES: Tasteful, Contemporary Renovations Blended with Old World Custom Millwork. Copious Amounts of Space, Storage & Functionality. 60â€™x40â€™ Metal Clad Quonset on Concrete Footings Complete w/ 220 & Radiant Heat + 18â€™ Power, Overhead Door Plus Mezzanine Storage. 5 Bedrooms. 4 Bathrooms. Barn + Multiple Sheds & Green House. Elevated, Maintenance Free Deck(s). Stone Retaining Wall. Approx 80% of Flowers are Annuals. Garden Irrigation System. Grassy, Tree Lined Meadow Area. This Property Exemplifies, Convenient Country Living in a Choice Locale

Built in 1980

Essential Information

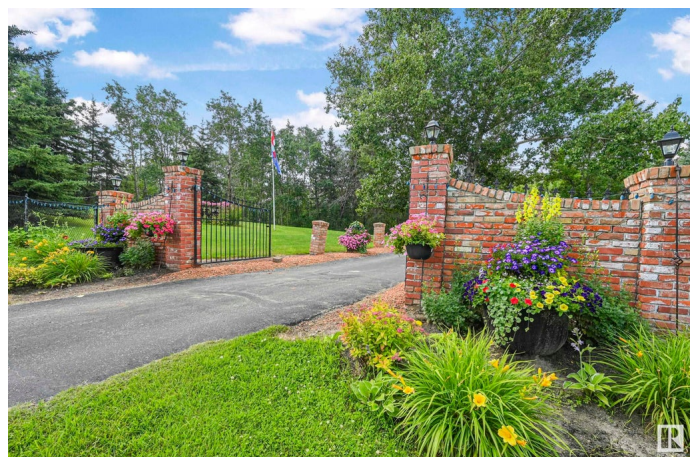
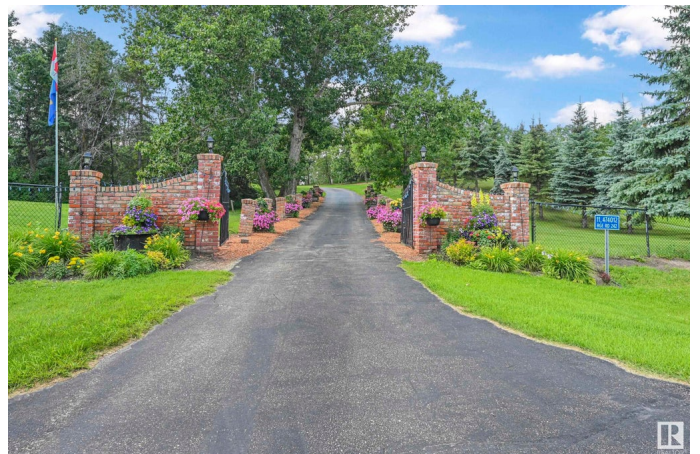

MLS® #	E4451014
Price	\$1,190,000
Bedrooms	5
Bathrooms	3.50
Full Baths	3
Half Baths	1
Square Footage	2,892
Acres	8.01
Year Built	1980
Type	Rural
Sub-Type	Detached Single Family
Style	2 Storey
Status	Active

Community Information

Address	11 474012 Rge Road 242
Area	Rural Wetaskiwin County
Subdivision	Nordic Place
City	Rural Wetaskiwin County
County	ALBERTA
Province	AB
Postal Code	T0C 1Z0

Amenities

Features	Air Conditioner, Deck, Fire Pit, Gazebo, Greenhouse, Hot Tub, Intercom, Patio, R.V. Storage, Walkout Basement, Workshop
----------	---

Interior

Interior Features	ensuite bathroom
Heating	Forced Air-2, In Floor Heat System, Natural Gas
Fireplace	Yes
Stories	3
Has Basement	Yes
Basement	Full, Finished

Exterior

Exterior	Wood
Exterior Features	Fenced, Fruit Trees/Shrubs, Golf Nearby, Hillside, Landscaped, Private Setting, Rolling Land, Treed Lot, Vegetable Garden

Construction	Wood
Foundation	Concrete Perimeter

Additional Information

Date Listed	August 2nd, 2025
Days on Market	1
Zoning	Zone 80

DATA IS DEEMED RELIABLE BUT IS NOT GUARANTEED ACCURATE BY THE REALTORS® ASSOCIATION OF EDMONTON. COPYRIGHT 2025 BY THE REALTORS® ASSOCIATION OF EDMONTON. ALL RIGHTS RESERVED.Trademarks are owned or controlled by the Canadian Real Estate Association (CREA) and identify real estate professionals who are members of CREA (REALTOR®, REALTORS®) and/or the quality of services they provide (MLS®, Multiple Listing Service®)

Listing information last updated on August 3rd, 2025 at 7:47pm MDT